

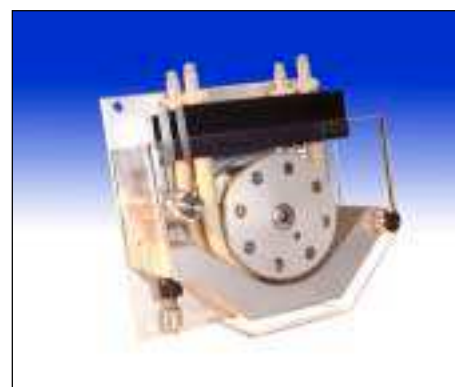

## 400F/L2 precision instrument quality two channel pump

### Technical information and features

- Accepts tubing elements in six standard sizes
- Spring loaded fully adjustable track for adaptability to various pressure conditions and maximising tube life
- Wide range of gear motors available
- Extremely precise in flow control in a flexible design
- Flow rates up to 600 ml/min
- Virtually pulse free when operated as one channel pump



400F/L2 precision instrument quality two channel pump

### Flow rate ranges (ml/min)

| Speed rpm | Tube bore and flow rates (ml/min) |        |        |        |        |        |
|-----------|-----------------------------------|--------|--------|--------|--------|--------|
|           | 0,8 mm                            | 1,6 mm | 2,4 mm | 3,2 mm | 4,0 mm | 4,8 mm |
| 12        | 0,66                              | 2,6    | 5,9    | 10     | 16     | 22     |
| 25        | 1,38                              | 5,5    | 12     | 21     | 33     | 46     |
| 30        | 1,65                              | 6,6    | 15     | 26     | 39     | 55     |
| 60        | 3,3                               | 13     | 29     | 51     | 79     | 110    |
| 100       | 5,5                               | 22     | 49     | 85     | 131    | 184    |
| 200       | 11                                | 44     | 98     | 170    | 262    | 367    |
| 350       | 19                                | 77     | 172    | 298    | 459    | 642    |

### 400F/L

*If you don't find exactly what you are looking for in this data sheet a customised product could be the solution.*  
 These pumps could be supplied with alternative drives and gear ratios, with a tube holder for continuous tubing and two, four or six channels, as a low pulsating pump with one, two or three channels, in alternative materials, fitted on a customised mounting panel and more.

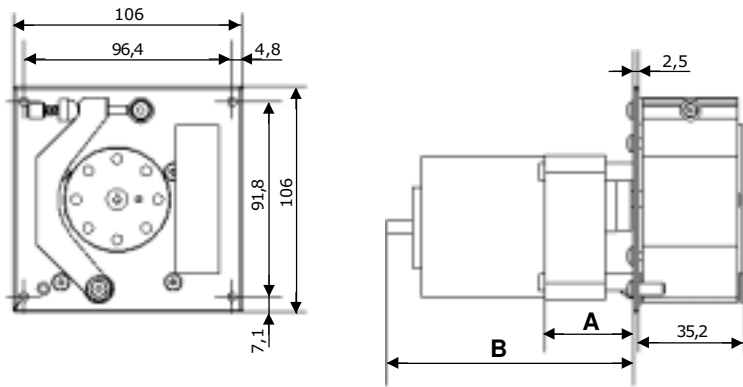

| Motor type: | Standard DC 30W      | Standard DC 5W      | Brushless DC 35W     |
|-------------|----------------------|---------------------|----------------------|
| Dimension A | L=41,3mm X Ø68,0mm   | L=41,3mm X Ø68,0mm  | L=41,3mm X Ø68,0mm   |
| Dimension B | L=115,2mm* X Ø68,0mm | L=93,4mm* X Ø68,0mm | L=103,4mm* X Ø68,0mm |

\* = maximum length behind mounting plate

| Product codes    |          |           |              |
|------------------|----------|-----------|--------------|
| Motor type       | Voltage  | Speed rpm | Product code |
| Standard DC 30W  | 12VDC    | 200rpm    | 040.MS1L.E2S |
| Standard DC 30W  | 24-30VDC | 200rpm    | 040.LS1L.E2S |
| Standard DC 30W  | 12VDC    | 100rpm    | 040.MP1L.E2S |
| Standard DC 30W  | 24-30VDC | 100rpm    | 040.LP1L.E2S |
| Standard DC 5W   | 12-15VDC | 60rpm     | 040.CM1L.E2S |
| Standard DC 5W   | 24-30VDC | 60rpm     | 040.EM1L.E2S |
| Standard DC 5W   | 12-15VDC | 25rpm     | 040.CC1L.E2S |
| Standard DC 5W   | 24-30VDC | 25rpm     | 040.EC1L.E2S |
| Standard DC 5W   | 12-15VDC | 12rpm     | 040.C81L.E2S |
| Standard DC 5W   | 24-30VDC | 12rpm     | 040.E81L.E2S |
| Brushless DC 35W | 24VDC    | 350rpm    | 040.NU1L.E2S |
| Brushless DC 35W | 24VDC    | 100rpm    | 040.NP1L.E2S |
| Brushless DC 35W | 24VDC    | 30rpm     | 040.NE1L.E2S |

#### Motor descriptions

|   |
|---|
| The <b>standard DC 30W</b> motor is our most powerful instrument quality motor. This motor features low electrical and audible noise, long brush life and excellent speed regulation with our controllers (optional). |
| The <b>standard DC 5W</b> motor is our most compact instrument quality motor. This motor features low electrical and audible noise, long brush life and excellent speed regulation with our controllers (optional).   |
| The <b>brushless DC 35W</b> motor is powerful with built in controller. No carbon brushes yields an extremely long life with no maintenance required.   |

#### 400F/L2

##### Materials of construction

|                 |                                       |
|-----------------|---------------------------------------|
| Rotor           | <i>Aluminium</i>                      |
| Rollers         | <i>Acid resistant stainless steel</i> |
| Roller bearings | <i>Carbon steel</i>                   |
| Track           | <i>Aluminium</i>                      |
| Tube holder     | <i>Acetal (Black)</i>                 |
| Shafts          | <i>Acid resistant stainless steel</i> |
| Mounting panel  | <i>Anodised aluminium</i>             |
| Springs         | <i>Acid resistant stainless steel</i> |
| Screws          | <i>Acid resistant stainless steel</i> |

#### 400F/L

If you don't find exactly what you are looking for in this data sheet a customised product could be the solution.

These pumps could be supplied with alternative drives and gear ratios, with tube holder for continuous tubing and two, four or six channels, as a low pulsating pump with one, two or three channels, in alternative materials, fitted on a customised mounting panel and more.



You can download the latest edition of this data sheet at [www.alitea.se](http://www.alitea.se).

W-M Alitea reserves the right to alter specifications without notice.